

exemplary shown article: 19433160292
item 1-3 excluding cable gland

6	19433160293	Han-Eco 16B Outd-HSM2-w. SL-M40-glanded	25,2	77,9	46	16-28	20,0	20,0
5	19433160292	Han-Eco 16B Outd-HSM2-w. SL-M32-glanded	11,2	51,0	36	13-21	4,0	15,0
4	19433160291	Han-Eco 16B Outd-HSM2-w. SL-M25-glanded	11,2	47,6	29	9-17	4,0	10,0
3	19432160293	Han-Eco 16B-HSM2-with SL-M40	25,2					
2	19432160292	Han-Eco 16B-HSM2-with SL-M32	11,2					
1	19432160291	Han-Eco 16B-HSM2-with SL-M25	11,2					
item	partnumber	partname	B	B1	SW	$\varnothing x$	①	②
							tightening torque Nm	

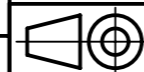

All Dimensions in mm
Original Size DIN A3

Scale
1:1,5

Free size tol.

Ref.

Sub.



All rights reserved
Department EL PD

Created by
HELLMANN

Inspected by
HERBRECHTSME

Standardisation

Date
2023-06-14

State
Final Release

Title
Han-Eco 16B Outd-HSM2-w. SL-Mxx-XX

Doc-Key / ECM-Nr.
100740407/UGD/004/B
50000247176

Type
TB

Number
19 43 Y16 029X

Rev.
B

Page
1/1

HARTING
D-32339 Espelkamp